

eternocivica



izonet
HIDROIZOLACIONI SISTEMI

ADJUSTABLE FLOOR SUPPORT
FOR DIFFERENT KINDS OF PAVING

STAR.T prilagodljivi distanceri

ključ za podešavanje

kompensator za pad
h- 2 mm

STAR.T
h- 8-15 mm

STAR.B
h- 5 mm



Star.T je početni distancer čija visina varira od 8 do 15 mm.

Ovaj sistem distancera **STAR.T** se koristi za visine od 8 mm do 30 mm.

Ukoliko Vam treba veća visina, to se postiže dodavanjem elementa **Star.B** visine 5 mm. Maksimalno su mogu dodati 3 elementa (15mm).

Postavljaju se lako i brzo, pokrivajući staro popločanje ili neku drugu vrstu podloge, dajući prostoru potpuno novi ugođaj.

Startni distanceri debljine samo 10 mm, dozvoljavaju postavljanje sistema i tamo gdje su male konstruktivne visine.

ETERNO

adjustable floor support



SE0

h- 28-38 mm

SE1

h- 37.5-50 mm

SE2

h- 50-75 mm

SE3

h- 75-120 mm

SE4

h- 120-170 mm

SE5

h- 170-215 mm

SE6

h- 140-230 mm

SE7

h- 185-275 mm

SE8

h- 235-325 mm

SE9

h- 205-345 mm

SE10

h- 250-385 mm

SE11

h- 300-400 mm

SE12

h- 270-455 mm

SE13

h- 315-500 mm

SE14

h- 365-550 mm



Possibility to conduct and hide different installations without difficulties, during construction and after it.

ETERNO program is used to overcome bigger differences at the height. It varies from 28 to 550 mm.

Unlimited possibilities of interventions like change of paving design, change of installations or recovery of waterproofing below paving.

Head of the adjustable support can be rotated and put in different angle, and that is how we can make floor completely flat although the surface below is under slope.



**moldings for concealing the joint
of waterproofing and paving**



**tiles spacers for aluminum joist
42x42 mm**



**noise insulating rubber for
aluminum joist
15x2 mm**



**aluminum joist
60x25 mm/L- 2000mm**

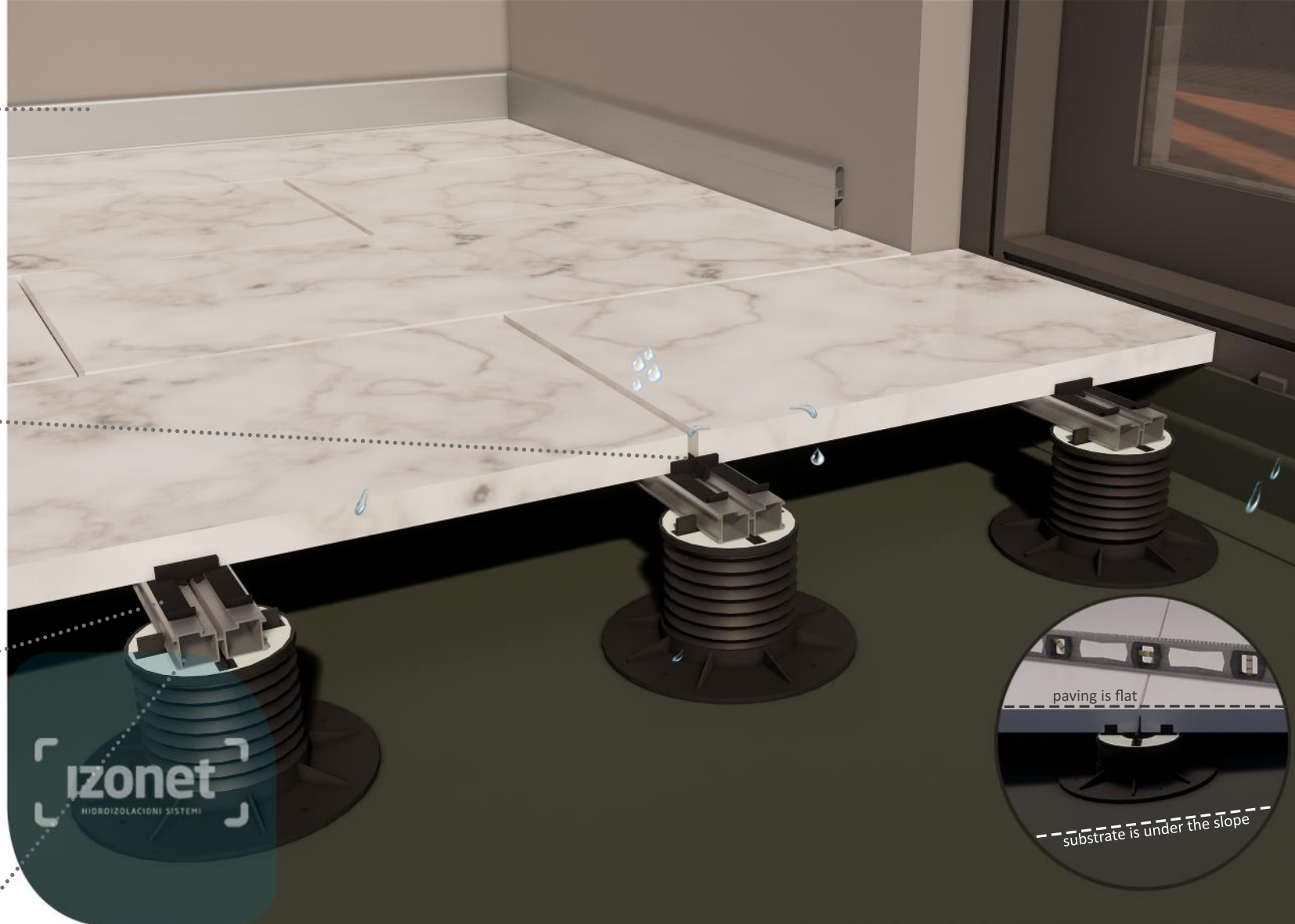

**There is an
option of insta-
lling paving on
an aluminum
joist as well.**

System of open
fugues efficiently
takes water and there
is no need for line
drain so it's more
economic.

There are no
damaged fugues or
calcification on the
stone paving.

Stone paving is co-
mpletely flat. Slopes in
construction for water
drain are hidden.
Mobilier stands flat and
stable on paving.

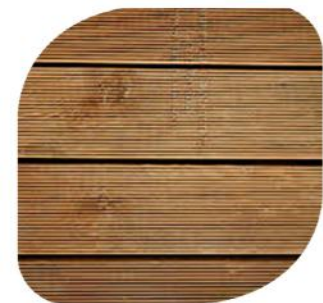
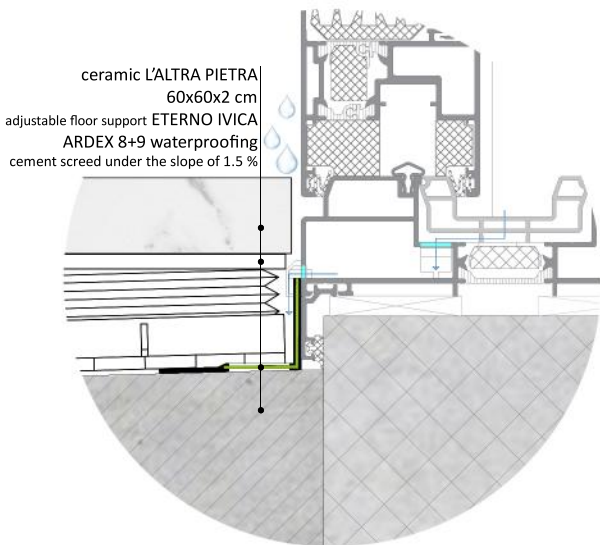

different types of
wooden flooring



concrete panels



**Beside ceramic and
stone paving, on alu-
minium joist you can
also put wooden or
concrete floor.**

It allows crossing
between interior and
exterior space with
same floor levels – for
example, finished floor
of the room and terrace
are on the same level.

This system allows us
to hide threshold (door-
step) of the terrace door,
so than we can have
clean walk line between
interior and exterior
space, without
barriers.



combination of the **pool**



and **ceramic**



set on the **adjustable floor support**

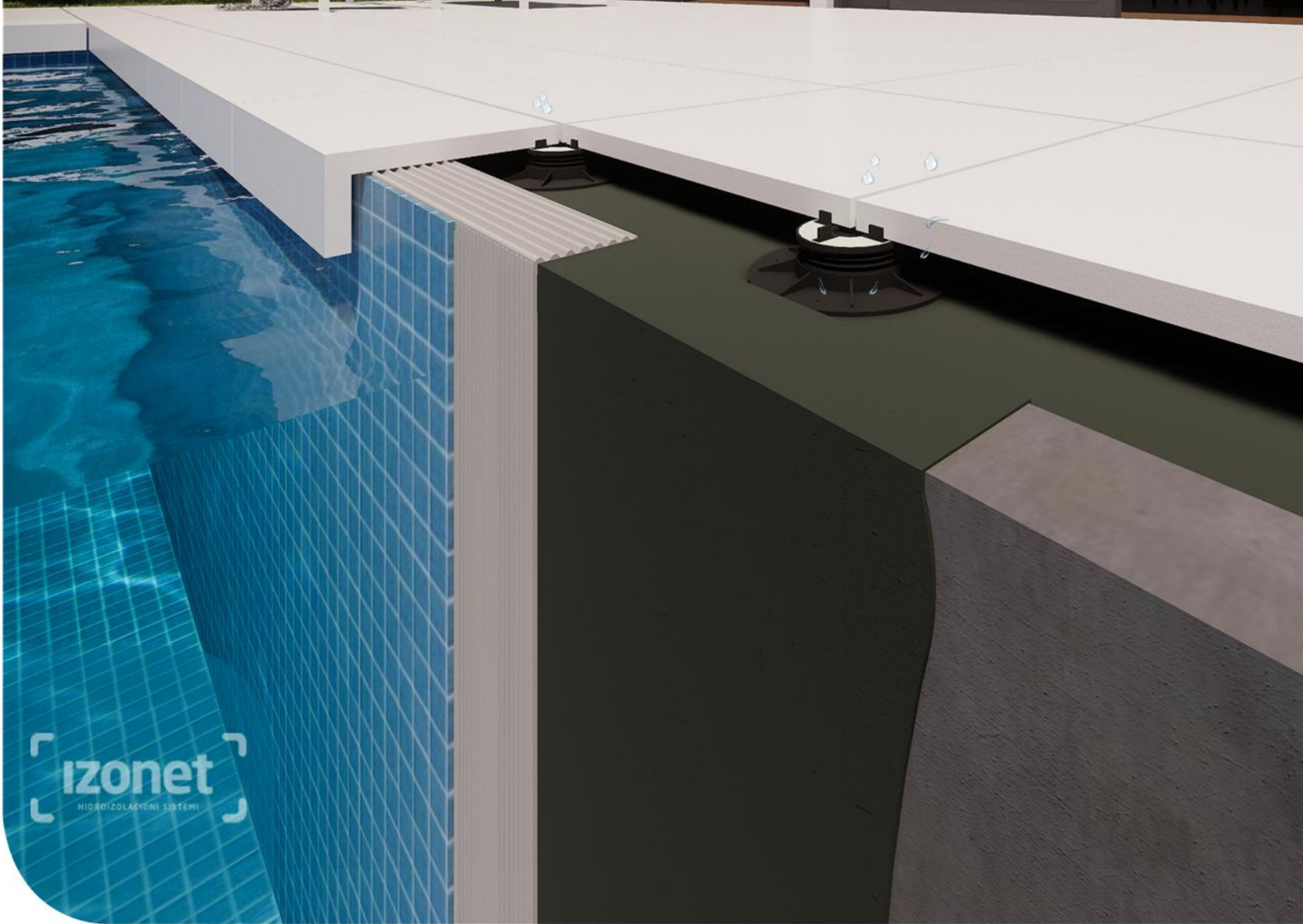

Strong mechanical
resistance on
impacts.

**Excellent solution
for pool areas.**

Freedom in creating
different architectural
solutions like combina-
tion: pool + green
roof + ceramic/stone
paving.

Waterproofing is not
loaded with other
layers that goes over it,
which is a case in clas-
sic paving systems (for
example – ceramics on
the adhesive layer).

Because of “air layer”,
which during the
summer cools the su-
rface and during the
winter prevent additio-
nal cooling, this system
is energy efficient.



combination of the **sedum roof**



and **ceramic**



set on **adjustable floor support**



Strong visual effect + simple implementation + economy.

Simplicity in combining different types of final layer.

Space between pavement and construction surface becomes in a significant termic and sound isolation.

The ceramic surface absorbs significantly less heat and cold.

Waterproofing system is not stiff and that is why stone paving system with adjustable support lasts much longer.